



You can make your **NEW HOUSE** safe against **EARTHQUAKE!**

FOLLOW 10 RECOMMENDATIONS

For Single Storey Masonry Houses in Cement Sand Mortar

2. Shape of House

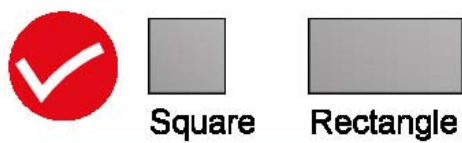

Square Rectangle

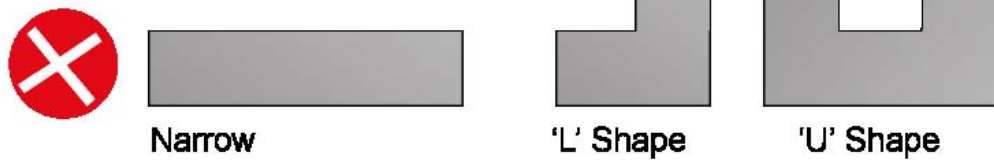

Narrow 'L' Shape 'U' Shape

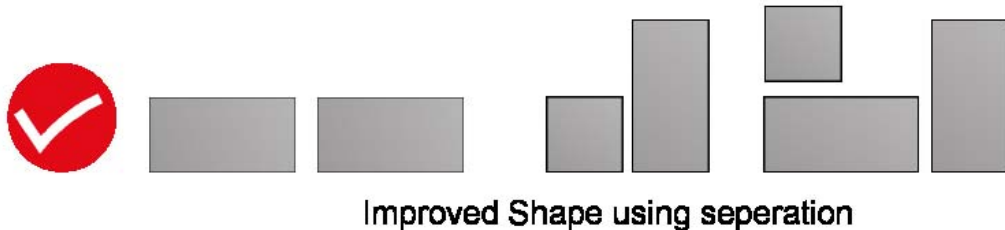

Improved Shape using separation

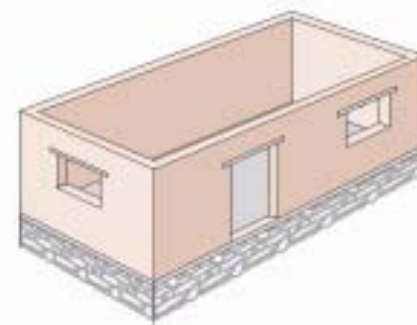

Avoid long walls

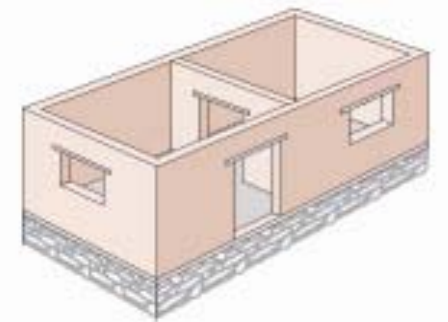

Provide sub-dividing walls

- Construct regular shaped houses like square, rectangular or circular;
- Subdivide complex shaped buildings by providing gaps at appropriate locations. The gap should be minimum 1 inch for one storied house;
- Avoid long and narrow structures. Length of a house should not be more than 3 times its width;
- Construct compact box type layout with all building components such as floor, walls and roof tied-up with each other;
- Maximum room size should be limited to 15ft x 15ft.



Canada

gtz



USAID
FROM THE AMERICAN PEOPLE

